

# State-Federal RPS Collaborative National Summit on RPS November 5-6, 2015

THE WESTIN CRYSTAL CITY, 1800 JEFFERSON DAVIS HWY  
ARLINGTON, VIRGINIA



## AGENDA (draft 102915)

### Day One - November 5 Jefferson 2 Ballroom – Level 2

---

#### 8:00-9:00 am **Registration and Continental Breakfast**

#### 9:00 am **Welcome and Overview of the Summit**

- Christopher Lawrence, Energy Policy Analyst, U.S. Department of Energy
  - Curtis Seymour, Program Director for the Power Sector, Energy Foundation
  - Warren Leon, Executive Director, Clean Energy States Alliance (CESA)
- 

#### 9:15 am **SESSION ONE** **RPS Trends**

This session will feature two presentations—the first on the overall status of RPSs around the country and observations about general trends, and the second will focus on legislative developments in 2015, as well as potentially in 2016, to either strengthen, weaken, or alter state RPSs.

##### **Presenters:**

- Galen Barbose, Research Scientist, Electricity Markets and Policy Group, Lawrence Berkeley National Laboratory (LBNL)
  - Justin Barnes, Director of Research, EQ Research
- 

#### 10:30 am **Break**

---

10:45 am

**SESSION TWO**

**The Benefits and Impacts of State RPS Programs**

Three of the authors of a forthcoming study by Lawrence Berkeley National Laboratory and the National Renewable Energy Laboratory (NREL) will give an advance look at their findings and the implications of those findings.

**Presenter:** Ryan Wisler, Senior Scientist and Deputy Group Leader, Electricity Markets and Policy Group, Lawrence Berkeley National Laboratory (LBNL)

**Panelists:**

- Galen Barbose, Research Scientist, LBNL
- Jeff Deyette, Assistant Director for Energy Research, Union of Concerned Scientists
- Jenny Heeter, Energy Analyst, Market and Policy Impact Analysis Group, National Renewable Energy Laboratory (NREL)

---

12:15 pm

**Lunch – Jefferson 3 Ballroom**

---

1:15 pm

**SESSION THREE**

**Clean Energy Cost and Technology Trends**

This will be a wide-ranging discussion among four expert panelists with expertise and varied perspectives on different clean energy technologies and market developments. The discussion will focus on specific technologies, especially solar and wind, but will also look at project development costs, federal tax policies, and general energy market trends.

**Moderator:** Warren Leon, CESA

**Panelists:**

- David Feldman, Senior Financial Analyst, Strategic Energy Analysis Center, NREL
- John Marciano, Partner, Chadbourne & Parke LLP
- Ryan Wisler, Senior Scientist, LBNL
- Ethan Zindler, Head of Policy Analysis, Bloomberg New Energy Finance

---

2:45 pm

**Break**

---

3:00 pm

**SESSION FOUR**

**Rapid-Fire RPS Issues, Topics, and Perspectives**

For this session, we encourage Summit attendees to raise RPS issues, topics, and perspectives. Any attendee who would like to offer a perspective or discuss a topic will have ten minutes to do so. There will then be opportunity for questions and brief discussion.

**Presenters:**

- Alli Gold Roberts, Associate, Policy Program, Ceres:  
“Why Businesses and Investors Support Renewable Portfolio Standards”
- Gus Simmons, Director of Bioenergy, Cavanaugh & Associates, P.A.:  
“RECs and RINs – The RPS Opportunity for Biogenic Carbon”
- Joel Stronberg, Policy Director, Renewable Energy Markets Association:  
“Adding Thermal Biomass To State RPS Programs: Opportunities and Challenges”

---

4:00 pm

**Break**

---

4:15 pm

**SESSION FIVE**

**Implications of EPA’s Clean Power Plan for State RPSs**

**Moderator:** Jennifer Martin, Executive Director, Center for Resource Solutions

**Presenters:**

- Matt Clouse, Acting Chief of the Energy Supply & Industry Branch in the Climate Protection Partnerships Division, Office of Air and Radiation, U.S. Environmental Protection Agency
- Ed Holt, Ed Holt and Associates
- Christopher Sherry, Policy Analyst, Climate Change Division of the Office of Atmospheric Programs, U.S. Environmental Protection Agency

---

5:30 -7:30 pm

**NETWORKING RECEPTION - Atrium**

---



---

## Day Two - November 6

Jefferson 2 Ballroom

*(Day Two sessions are open only to representatives from state agencies and the federal government)*

---

9:00 am

### SESSION ONE

#### RPS Developments and Best Practices

This session will feature presentations from several states on recent developments and best practices.

**Moderator:** Julie Peacock, Senior Policy Analyst, Oregon Department of Energy  
**Presenters:**

- Kevin Fink, Policy Analyst, Vermont Public Service Board: “The New Vermont RPS”
- Angela Gould, RPS Verification and Compliance Technical Lead, California Energy Commission: “California’s Newly Enacted 50 Percent RPS”
- Doreen Harris, Large Scale Renewables Program Manager, NYSERDA: “The Next Phase in the New York RPS” (tentative)
- Ronald Jackson, Research Scientist, New Jersey Board of Public Utilities: “The Status of the New Jersey RPS”

---

10:15 pm

Break

---

10:30 am

### SESSION TWO

#### RPS Data Collection and Compliance Reporting Practices

The session will look at the role of information sharing in RPS program management. It will identify best practices in data collection and reporting. It will show how states can get more value out of the data potentially available to them. There will be opportunity for attendees to explore options for improving their state’s practices.

**Moderator:** Warren Leon, CESA

**Panelists:**

- Howard Bernstein, Energy Portfolio Standards Program Manager, Massachusetts Department of Energy Resources

- Jason Gifford, Senior Director, Sustainable Energy Advantage, LLC
- Mary Frantz, Senior Program Analyst, WREGIS
- Lars Kvale, Head of Business Development, APX Environmental Markets

---

**12:00 pm Lunch – Jefferson 3 Ballroom**

---

**1:00 SESSION THREE**

**Small Group Discussions of RPS Issues**

The state representatives who register for the conference will be asked to suggest possible topics for small group discussions.

---

**2:00 Break**

---

**2:15 SESSION FOUR**

**Implications of Solar Investment Tax Credit Reversion for State RPSs**

With the solar investment tax credit (ITC) scheduled to drop from 30 percent to 10 percent in 2017, there could be shortages of RECs or higher costs of compliance in some states, especially those with solar carve-outs. Jenny Heeter will present key findings and implications of a recent NREL report on the potential impacts of ITC reversion.

**Presenter:**

- Jenny Heeter, NREL

---

**3:30 SESSION FIVE**

**The Future of State RPS**

This will be a broad-ranging discussion among the attendees of the future of state RPSs across the country over the next 5-10 years.

**Moderator:**

- Warren Leon, CESA

---

**4:00 ADJOURN**

---

### Crystal City Metro

The Crystal City Metro Station is conveniently located next to the hotel. **This metro station services the Blue and Yellow Metro lines**, which will bring you to downtown DC and Reagan National Airport in just minutes. Below is some helpful information for planning your next trip to Crystal City and the DC Metro Area.

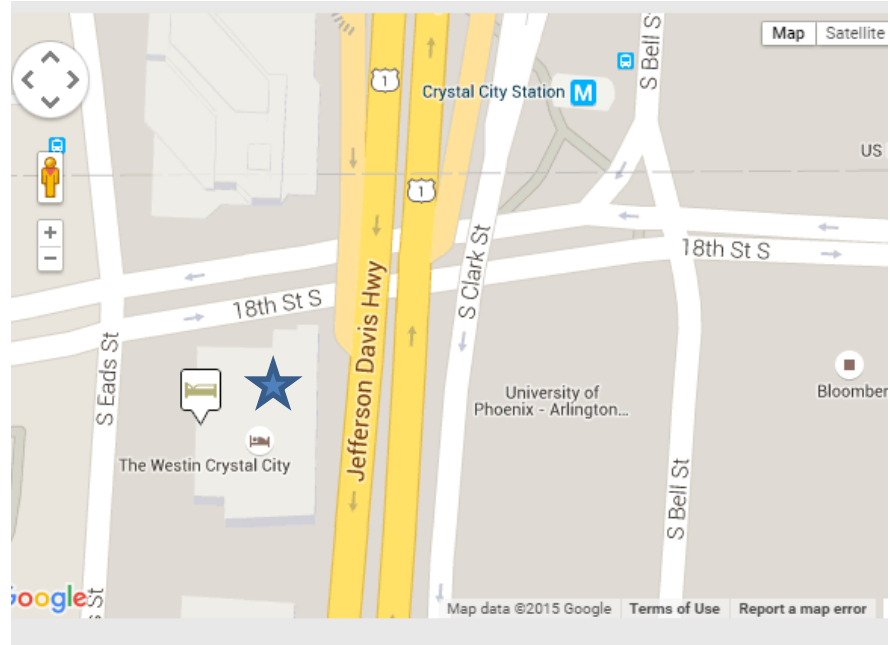

### Westin Crystal City Floor Plan – Level 2

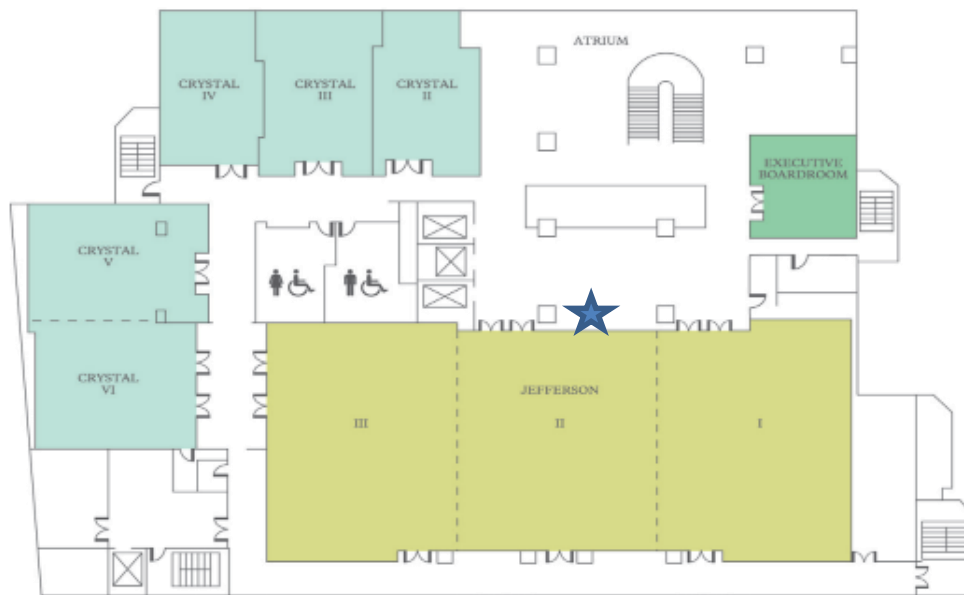

### 2015 National Summit on RPS

hosted by

**Clean Energy States Alliance**

with funding support from

**The Energy Foundation and the U.S. Department of Energy**

